

GREAT NEIGHBORHOODS HAVE ...



Great people, of course... architecture and gardens. Quality services and rare finds. Good places to eat.



But what makes a neighborhood truly exceptional are the things that bring us out of our homes and bring us together. Clack's Corner is a project many will contribute to, in different ways, and a space where we will connect and enjoy being with our neighbors.



CLACK'S CORNER, A NEIGHBORHOOD PARK

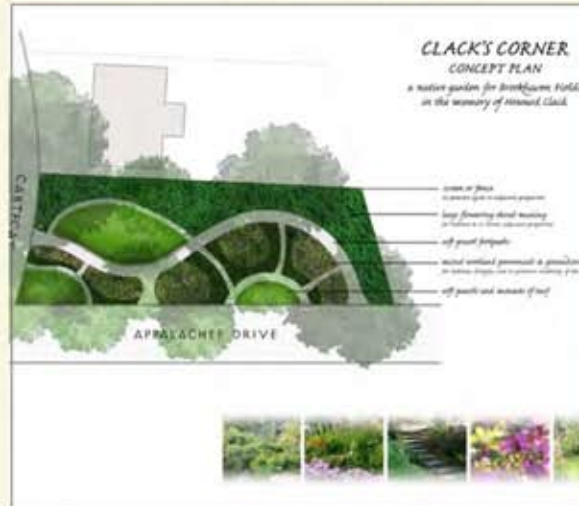

This landscape plan was drawn and contributed by Adam Clack, ASLA, Denver CO, Howard Clack's nephew. This is not the final plan.

AT THE CORNER OF APPALACHEE AND CARTECAY DRIVE 30319

It's a destination. A neighborhood gathering spot. A garden. An anchor to treasures of the past in a busy urban community. What will the Park at Clack's Corner be for you? Leave your mark on the neighborhood with a donation to develop and preserve Clack's Corner for our community.

Make your tax-deductible donation to:
Park Pride - Development Department
233 Peachtree St. NE, Suite 1600
Atlanta, GA 30303

or on-line at
WWW.PARKPRIDE.ORG
Click on Make a Donation, at the bottom of the page and specify Clack's Corner

DONATION QUESTIONS?
CALL MEREDITH: 404-816-3352 OR
EMAIL BENTLEY: BBMARANE@COMCAST.NET

CLACK'S CORNER

A Neighborhood Park in Brookhaven Fields



Making Life Good in the Neighborhood

How will this little park make life good?

Here's how other neighbors responded:

I think Clack's Corner will be a quiet place to read or to take my little one to look at the plants as we walk around the neighborhood every day.

For our family Clack's will be a 'backyard' for us with our children, to explore and relax.

..might be a good place for neighborhood ghost stories around Halloween (or general story time reading for neighborhood kids.)

It will be a great spot for neighborhood events. Finally we can get off the streets with our Halloween Parade and our Spring Fling!

..a place to meet people with my coffee for a break in the middle of the workday. Or maybe take a lunch. Sometimes I may want to sit alone...mostly I would like to sit on a bench or stone wall and visit with someone, or have a game of checkers or cards on a small stone table between 2 chairs.

I would like it to be a place where we can stop and bump into our neighbors, talk for a few minutes, meet their children and dogs... trade news.

The book club could meet there in nice weather.

I'd like a bench or low wall where we can sit in the shade; native flowers that draw butterflies; maybe a bird house and a bird feeder that we'd be

willing to fill sometimes if others will help out too.



A Great Neighborhood

HAS BEAUTY, ART, HEART AND A QUALITY OF CONNECTEDNESS THAT SAYS "LIFE IS GOOD"



MAKE A DONATION NOW AND THE PARK WILL BE OURS FOREVER

Giant Oak: Contributors will be included on the commemorative sign, recognized in the neighborhood newsletter and Web site plus all other benefits. \$2500+

Owl's Nest: Recognition in the neighborhood newsletter delivered to every resident and on the Website; plus two bricks and be a VIP at the park opening. \$1000

Dragonfly: Only \$1 per day for one year and the park will be yours to use forever! Designate two bricks with your words and be a VIP at the opening. \$365

Wildflower: For the cost of four latte's a month contributors will be VIP's at the park opening and receive one brick with your choice of wording. \$240

Bricks: Leave a legacy on the park's winding path with your choice of words on a commemorative brick. \$100

Howard Clack was born in this house and lived here until his death in 2006. He was often seen walking or heard playing the piano. This park is the fulfillment of his wish for it to be a public greenspace. DeKalb County purchased the property to be used as a park, however, the park must be designed, installed and maintained with private funds. The Clack Family has made a generous \$10,000 contribution to the park in Howard's memory. BFCA has committed \$1000 for installation, in addition to overseeing the maintenance. Park Pride is the fiscal partner for the project.

IN THE HEART OF BROOKHAVEN FIELDS

A central location to meet one friend or many... the backdrop for neighborhood stories and warm memories... many neighbors have already given to the park. One neighbor said it well: *It is a quirky little park in a quirky neighborhood where everyone is welcome if you are willing to join in.* Please join in.



DONATION LEVELS

GIANT OAK	RECOGNITION ON PARK SIGNAGE	\$2,500 OR MORE
OWL'S NEST	NEWSLETTER RECOGNITION	\$1,000
DRAGONFLY	2 BRICKS + VIP	\$365
WILDFLOWER	1 BRICK + VIP	\$240
BUY A BRICK	LEAVE A LEGACY	\$100